

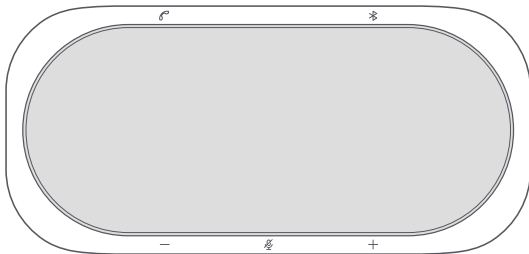

## Prestel SP-112/112W

AI Conference Speakerphone



**USER MANUAL**

# Product Introduction

---

SP-112/112W is a 360° noise-canceling conference microphone speaker designed specifically for enterprise conference rooms. It is an intelligent conference microphone speaker that combines sound collection, sound amplification, speech transcription, and subtitle simultaneous transmission. The product uses a 12-element omnidirectional microphone array and achieves 5-meter radius omnidirectional sound collection, intelligent noise reduction, echo cancellation, real-time speech transcription, and other functions through audio algorithms. It solves the conference pain points such as unclear remote calls, noisy environments, and difficulty in organizing meeting minutes for users. The built-in high-fidelity speakers enable users to hear clearly and maintain efficient communication. With the support of 5 units cascading technology, this product can achieve a wider sound collection range and can be deployed in larger conference rooms.

Applicable scenarios: Conference rooms of various sizes.

# Product Introduction

---

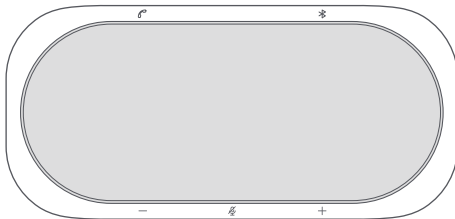

SP-112/112W



USB cable

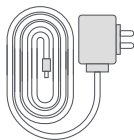

Power adapter

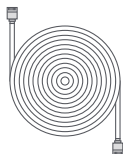

Ethernet cable



Dongle



User manual

\*Dongle Only for SP-112W

# Product Introduction

---

## Buttons and indicator lights instructions

📞 Hang up/ Answer (TBD)

📶 Bluetooth

Press and hold 2 seconds to enable or disable

Indicator status:

White light on:bluetooth connected

White light flashing:bluetooth pairing

Light off:bluetooth disabled

\*Only for SP-112W

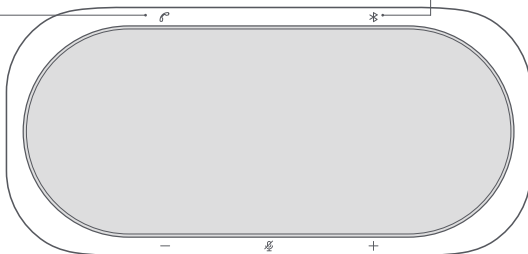

# Product Introduction

---

## Buttons and indicator lights instructions

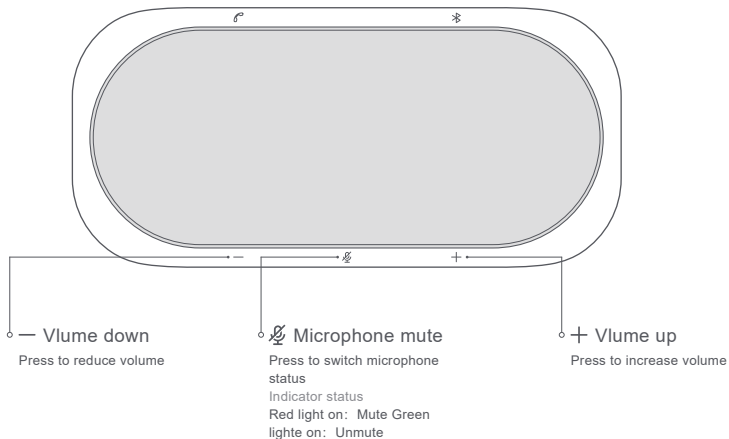

# Product Introduction

---

## Light color instructions

|           |                        |
|-----------|------------------------|
| Status    | Indicator status Green |
| Power on  | light on Green light   |
| Standby   | breathing Green light  |
| Unmute    | Red light on           |
| Mute      | Light off              |
| Sleep     | Blue light breathing   |
| Ungrading |                        |

# Product Introduction

---

## Interface instructions

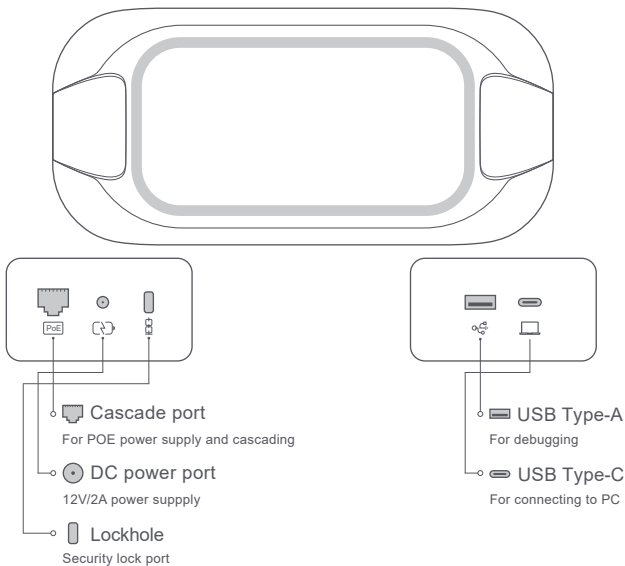

# Instruction for use

---

## 1.Device connection

### \* USB connection

Power on device,connect the device to the computer through the attached USB cable. When you hear the prompt tone, the connection is successful.

### \*Bluetooth connection ( \* Only for SP-112W)

Power on device, the bluetooth name is "SP-112W\*\*\*\*"(the last four figures of S/N).

#### 1) Bluetooth Dongle connection

Insert the Bluetooth Dongle into a PC or conference screen,activate the Bluetooth of SP-112W, open the Bluetooth settings page of the computer system, select SP-112W to connect. The d-evice's Bluetooth indicator light staying on indicates a successful connection.

#### 2) Computer bluetooth connection

After powering on device and activating Bluetooth, then open the bluetooth settings page on your computer. Select this device to pair and connect. The device's Bluetooth indicator light staying on indicates a successful connection.

#### 3) Mobile phone connection

After powering on device and activating Bluetooth, then turn on the Bluetooth function on your mobile phone and search for Bluetooth device named "SP-112W- \*\*\*\*" for pairing and connection.

Tip: This device does not support direct connection to the phone using an OTG data cable.



# Instruction for use

---

## 2.Devices cascaded

\*Cascaded connection (via Ethernet cable)

- 1) Applicable for cascade usage of two SP-112/112W devices.
- 2) Power on and start the first device using the power adapter.
- 3) The first device enters standby mode and the light shows green breathing status.
- 4) Power on the second device using the power adapter, and then connect it to the first device using the Category 6 Ethernet cable.
- 5) After successful cascading, the devices enter standby mode, and the light shows green breathing status.

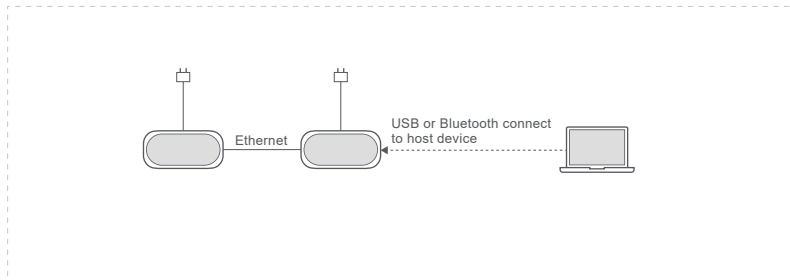

Diagram of cascaded via Ethernet cable

# Instruction for use

---

## 2.Devices cascaded

\*Cascaded connection (via POE switch)

- 1) Applicable for cascade usage of 2 to 5 SP-112/112W devices
- 2) The first device is connected to the POE switch via a Category 6 Ethernet cable (included in the package), powered on and activated.
- 3) The next device is also connected to the POE switch via a Category 6 cable (included in the package), powered on and activated.
- 4) After successful cascading, the devices enter standby mode, and the light shows a green breathing status.
- 5) Repeat step 4 to cascade up to 5 devices.

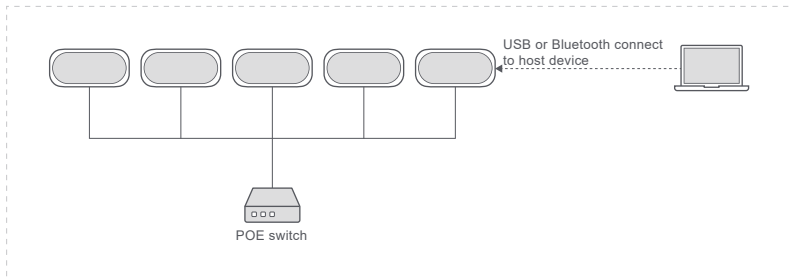

Diagram of cascaded via POE switch

# Instruction for use

---

## 2.Devices cascaded

### \* Master/Slave devices

- 1) The computer is connected to any device via USB or Bluetooth, and the connected device is the "ma-ster device", while other cascaded devices are "slave devices".
- 2) The device status of the "master device" and "slave devices" are synchronized, and the button presses and light effects are also synchronized.

Note: The device that completes the USB connection first is the master device.

# Basic Parameter

|                      |                                |                                |
|----------------------|--------------------------------|--------------------------------|
| Product Name Product | AI Conference Speakerphone     |                                |
| Model Product        | SP-112W                        | SP-112                         |
| Dimensions Bluetooth | 250mm*119mm*39mm Bluetooth     | 250mm*119mm*39mm               |
| Microphone           | V5.1                           | --                             |
| Pickup Radius        | 12 omnidirectional analog MEMS | 12 omnidirectional analog MEMS |
| Speakers             | 5 meters                       | 5 meters                       |
| Cascade mode         | 8W*2                           | 8W*2                           |
| Cascading Quantity   | POE Ethernet cable             | POE Ethernet cable             |
| Adapter Power Supply | 2 units~5 units                | 2 units~5 units                |
| POE Power Supply     | 12V 2A                         | 12V 2A                         |
|                      | IEEE 802.3at standard          | IEEE 802.3at standard          |